

# 2~8°C / -10~-26°C Combined Refrigerator & Freezer

*Brand New Appearance*

*Separate Control of Refrigeration & Freezing*



## YCD-EL289



### Environmentally Friendly & High-efficiency

Environmentally-friendly Freon-free refrigerant and high-efficiency compressor supplied by an international famous brand ensure energy saving and high efficiency.

### Refrigeration System

Two compressors and separate control of the upper refrigeration chamber and the lower freezing chamber.

### High-precision Computerized Temperature Control

The digital temperature display can indicate operating status clearly, and users may set the high temperature/low temperature alarm points based on their needs.

### Thermal Insulation System

The CFC-free polyurethane foam technology and the thicker insulating layer can improve the effect of thermal insulation.





### Temperature Control System

- High-precision microcomputer temperature control system with build-in control/alarm sensors for high/low temperature, ambient temperature and evaporator temperature etc. ensuring the safe and stable running;
- 1 inch high brightness digital temperature display with 0.1°C display precision; the temperature can be set freely.



### Refrigeration System

- Equipped with high-efficiency compressor and international brand fan, ensuring energy saving and silent running;
- Two compressors and separate control of the upper refrigeration chamber and the lower freezing chamber.



### Security System

- Perfect audible and visual alarm system makes it safer for storage. Equipped with alarm functions including high/low temperature alarm, high ambient temperature alarm, sensor failure alarm, door ajar alarm, power failure alarm etc;
- Buzzer alarm for the door opening more than 1 minute, alarm automatically muted when the door is closed.



### Human-oriented

- The interior is equipped with 3 drawers + 4 shelves for object storage;
- Casters at the bottom with locking device for easy movement.

## Scope of Application

Suitable for use in scientific research, cryogenic test on special materials, blood plasma cryopreservation, low temperature resistance test on biological materials, vaccines, biological products and military products, etc. Suitable for use in research institutions, the electronic industry, the chemical industry, hospitals, the health, & disease prevention system, laboratories in colleges & universities, military enterprises, etc.

## Performance Data / Cooling Curve

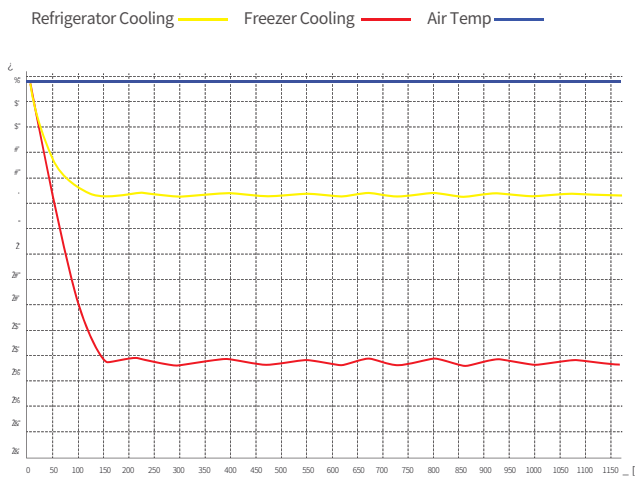

## External Dimensions

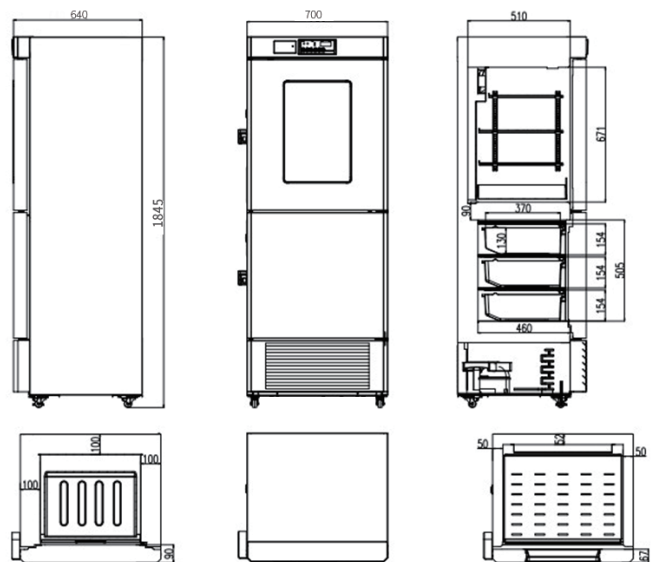

| 2~8°C /-10~-26°C Combined Refrigerator & Freezer |   |
|--|---|
| Model  | YCD-EL289   |
| Cabinet Type                                     | Upright   |
| Capacity(L)                                      | 289,R:189,F:100   |
| Internal Size(W*D*H)mm                           | R:600*510*710, F:500*460*505  |
| External Size(W*D*H)mm                           | 700*640*1845  |
| Package Size(W*D*H)mm                            | 812*747*2004  |
| NW/GW(Kgs)                                       | 140/162   |
| Performance                                      |   |
| Temperature Range                                | R:2~8, F:-10~-26  |
| Ambient Temperature                              | 16-32   |
| Cooling Performance                              | R:5, F:-26  |
| Climate Class                                    | N   |
| Controller                                       | Microprocessor  |
| Display  | Digital display   |
| Refrigeration                                    |   |
| Compressor                                       | 2pcs  |
| Cooling Method                                   | R: Forced air cooling , F:Direct cooling                            |
| Defrost Mode                                     | R:Automatic, F:Manual   |
| Refrigerant                                      | R600a   |
| Insulation Thickness(mm)                         | R:50, F:100   |
| Construction                                     |   |
| External Material                                | Spraying steel plate  |
| Inner Material                                   | Stainless steel   |
| Shelves  | R:3+1(Stainless steel),F:3(ABS)                                     |
| Backup battery                                   | Yes   |
| External Lock                                    | Yes   |
| Access Port                                      | 2pcs. Ø 25 mm   |
| Casters  | 4 (2 casters with brake)  |
| Data Logging/Interval/Recording Time             | USB/Record every 10 minutes / 2 years                               |
| Door with Heater                                 | Yes   |
| Alarm  |   |
| Temperature                                      | High/Low temperature, High ambient temperature                      |
| Electrical                                       | Power failure,Low battery   |
| System   | Sensor failure,Door ajar,USB datalog failure, Communication failure |
| Electrical                                       |   |
| Power Supply(V/HZ)                               | 220-240~/50   |
| Power(W)   | 240   |
| Power Consumption(KWh/24h)                       | 3.55  |
| Rated Current(A)                                 | 1.85  |
| Accessories                                      |   |
| Standard   | RS485, Remote alarm contact   |

\*The model, parameters and performance specified in this brochure may be changed without prior notice because of product upgrading.

\*There may be differences between the product images shown in this brochure and the actual products. When you are buying any product, please check the actual product.