

# -40°C Ultra-low Temperature Freezer

*Targeted Refrigeration • Fast Refrigeration  
Energy-saving & Environmentally Friendly*



## DW-FL678



### Refrigeration System

- Freon-free refrigerant, compressor supplied by an international famous brand and EBM fan can guarantee fast cooling and are energy-saving and environmentally friendly;
- Refrigerating circuit with proprietary intellectual property rights ensures high efficiency and stability;
- The insulated foamed outer door with seal design prevents loss of cooling capacity effectively;

### Temperature Control System

High-precision microcomputer temperature control system and platinum resistor temperature sensors ensure more precise temperature control.

### People-oriented Design

High-quality steel plate structure with phosphate coating, Galvanized steel liner and low noise design can create a comfortable environment.



### High-precision Temperature Control

- The digital temperature display can show various parameters simultaneously, such as temperature inside the cabinet, power voltage and environmental temperature, indicating operating status clearly;
- The high-precision microcomputer temperature control system and platinum resistor temperature sensors enable users to set temperature inside the cabinet within a range from -20°C to -40°C.



### Refrigeration System

- EBM fan are powerful, energy-saving and highly efficient;
- The large-area finned condenser is characterized by a space equal to or less than 2mm between fins, providing a large area for heat dissipation and satisfactory performance.



### Human-oriented

- Door handle with lock for safety operation;
- The adjustable layered structure is convenient for storage of various things;
- The liner made from High quality galvanized steel sheet for medical use is low-temperature tolerant and corrosion-resistant, which has a long service life and is easy to clean.



### Thermal Insulation System

- The insulated foamed outer door with seal design prevents loss of cooling capacity effectively;

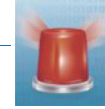

### Security System

- High/low temperature alarm, power failure alarm, door ajar alarm, system failure, communication error, high ambient temperature, condenser overheating alarm etc;
- Startup delay and stop interval protection function to ensure reliable operation;
- Keyboard lock and password protection function to prevent arbitrary adjustment of operating parameters;
- Safety door lock design, ensure sample storage is more secure.



### Chart Recorder (optional)

- Equipped with a printer;
- The filtering screen is removable and easy to clean.

## ✓ Scope of Application

Suitable for use in scientific research, cryogenic test on special materials, blood plasma cryopreservation, low temperature resistance test on biological materials, vaccines, biological products and military products, etc. Suitable for use in research institutions, the electronic industry, the chemical industry, hospitals, the health & disease prevention system, laboratories in colleges & universities, military enterprises, etc.

## 🔗 Performance Data / Cooling Curve

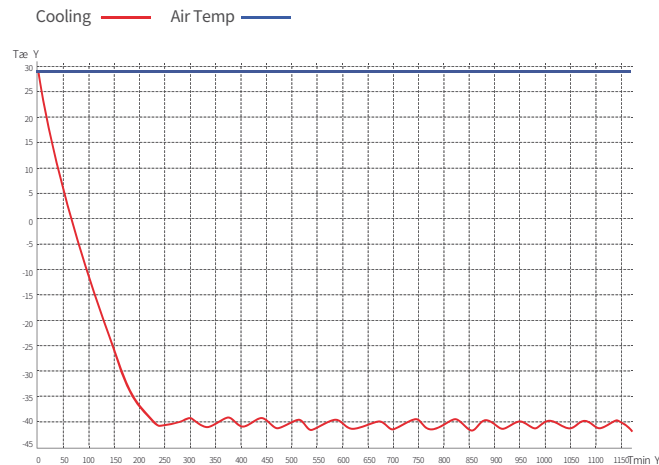

## 📐 External Dimension

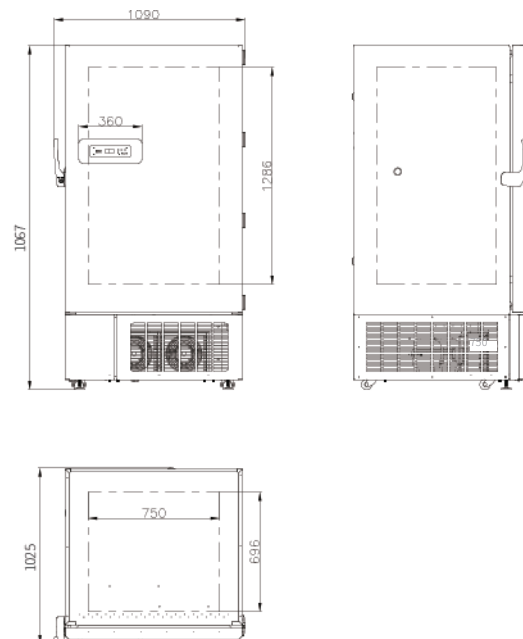

## Specification Chart

<b>-40°C Ultra-low Temperature Freezer</b>	
<b>Model</b>	DW-FL678
<b>Cabinet Type</b>	Upright
<b>Capacity(L)</b>	678
<b>Internal Size(W*D*H)mm</b>	750*696*1286
<b>External Size(W*D*H)mm</b>	1090*1025*1955
<b>Package Size(W*D*H)mm</b>	1203*1155*2171
<b>NW/GW(Kgs)</b>	258/342
<b>Performance</b>	
<b>Temperature Range</b>	-20~-40°C
<b>Ambient Temperature</b>	16-32°C
<b>Cooling Performance</b>	-40°C
<b>Climate Class</b>	N
<b>Controller</b>	Microprocessor
<b>Display</b>	Digital display
<b>Refrigeration</b>	
<b>Compressor</b>	2pcs
<b>Cooling Method</b>	Direct cooling
<b>Defrost Mode</b>	Manual
<b>Refrigerant</b>	R290
<b>Insulation Thickness(mm)</b>	130
<b>Construction</b>	
<b>External Material</b>	High Quality Steel plates with spraying
<b>Inner Material</b>	Galvanized steel sheet
<b>Shelves</b>	3(stainless steel)
<b>Door Lock with Key</b>	Yes
<b>External Lock</b>	Yes
<b>Access Port</b>	3pcs. Ø 25 mm
<b>Casters</b>	4(2 leveling feet)
<b>Data Logging/Interval/Recording Time</b>	USB/Record every 10 minutes / 2 years
<b>Backup Battery</b>	Yes
<b>Alarm</b>	
<b>Temperature</b>	High/Low temperature,High ambient temperature
<b>Electrical</b>	Power failure, Low battery
<b>System</b>	Sensor failure, Condenser overheating, Door ajar, Communication error,Built-in datalogger USB failure
<b>Electrical</b>	
<b>Power Supply(V/HZ)</b>	220-240~/50
<b>Power(W)</b>	730
<b>Power Consumption(KWh/24h)</b>	10.11
<b>Rated Current(A)</b>	8.37
<b>Accessories</b>	
<b>Standard</b>	RS485, Remote alarm contact
<b>Optional</b>	Printer,Chart recorder

\*The model, parameters and performance specified in this brochure may be changed without prior notice because of product upgrading.

\*There may be differences between the product images shown in this brochure and the actual products. When you are buying any product, please check the actual product.